

A-A

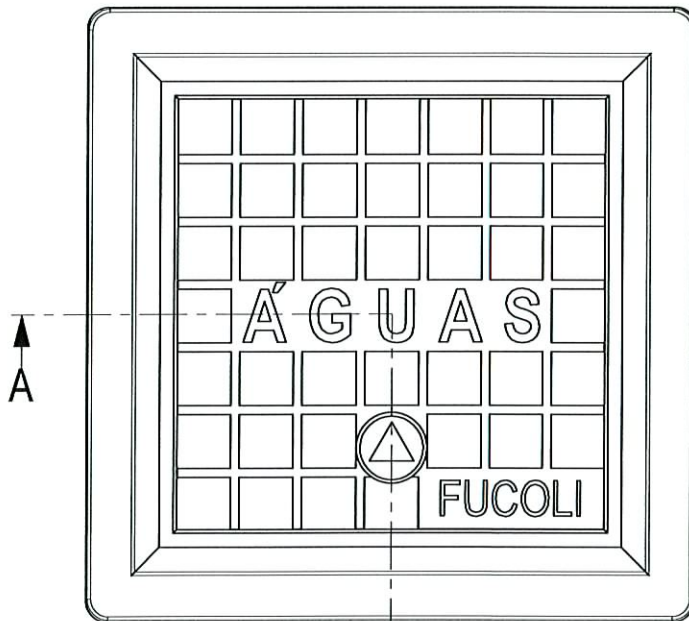

A →

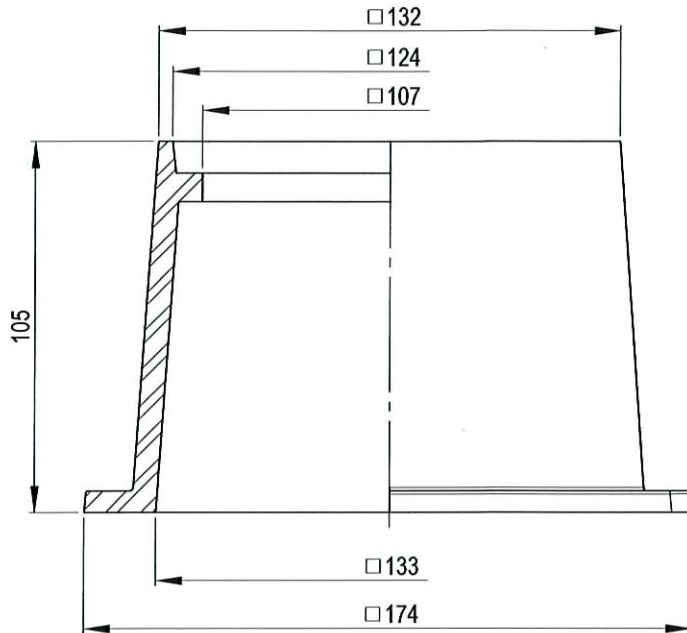
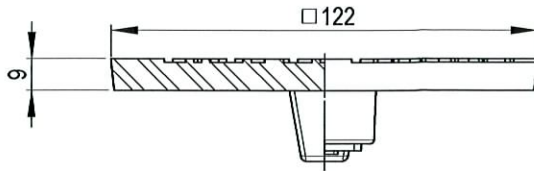
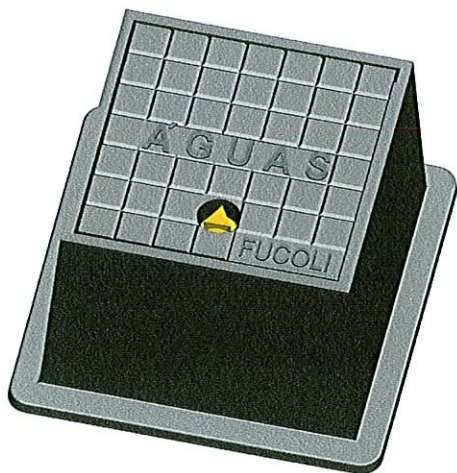

TAMPA **1,1** Kg (cód. 204.15.005)
 PESO APROX.
 ARO **3,2** Kg (cód. 204.21.005)

	DATA	RÚBRICA	MATERIAL	
DESENHOU	15/10/2010		FERRO FUNDIDO NODULAR(DÚCTIL)	 Fucoli - Somepal FUNDAÇÃO DE FERRO, S.A.
APROVOU	15/10/2010			
ESCALA	DESIGNAÇÃO			DESENHO Nº
-	TAMPA+ARO 12x12 N T/ÁGUAS FIGUEIRA DA FOZ			204.15.006
TOLER. ISO 8062 CT 9				REV. Nº 0 FOLHA 1 DE 1 SUBSTITUI REV. SUBSTITUIDO POR