

Pormenor - C

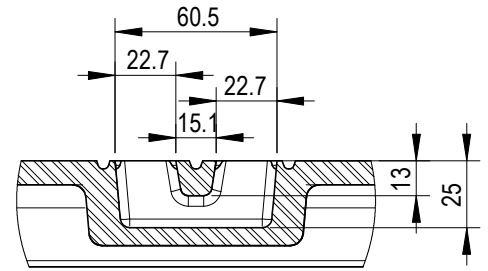

A-A

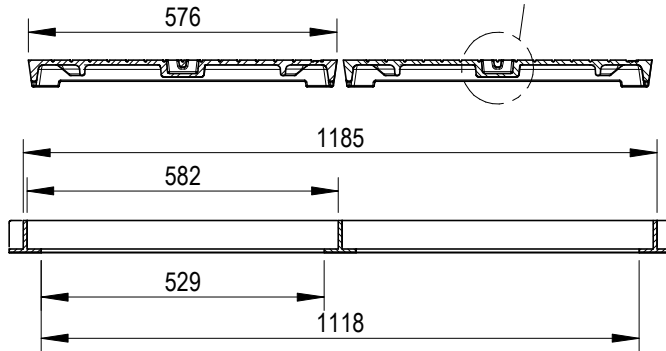

Pormenor - D

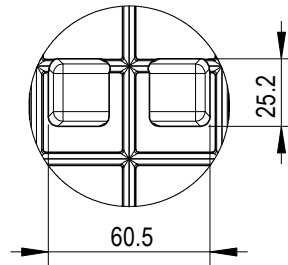

B-B

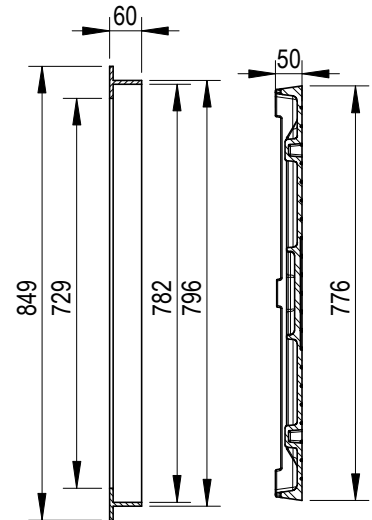
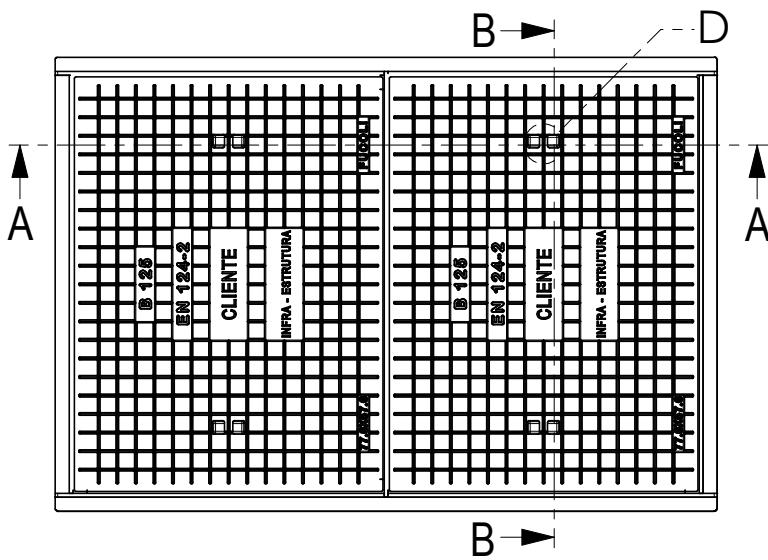

DESIGNAÇÃO

**TAMPA + ARO RECT. 1210x807 B125 N
T/ TELECOM**



COMPONENTE	PESO (Kg)	CARACTERÍSTICAS	
TAMPA [204.26.038]	2x38,8	RELEVO TAMPA	68,4 %
ARO [204.30.022]	29,0	COTA DE PASSAGEM	529 mm
		SUP. APOIO DO ARO	0,45 N/mm ²

DESENHO Nº

204.26.031

TOLER. ISO 8062-3 DCTG9

REV. Nº

DATA

5

31/07/2020