

DOUBLE FUNCTION AIR VALVE

series DOUBLE WIND

DN 20 - 100 PN10/16

06.200



Product description

- Double function air valve DOUBLE WIND for drinking water, prepared for water supply in firefighting and irrigation systems
- Service temperature from 0°C (excluding frost) to 70°C

Standards

- Designed according to EN 1074-4
- Flange drilling to EN 1092-2 PN10/16
- Internal parallel BSP thread (Type G) according to ISO 228-1 and ISO 1179-1

Tests

All valves are individually hydrostatically tested according to EN 1074-4:

- Seal 1.1 x PN (in bar); Body: 1.5 x PN (in bar)

Corrosion protection

- Epoxy powder coating RAL 5005
- Applied internal and external with a minimum coating thickness of 250 µm
- Potable water approved epoxy coating fusion bonded according EN 14901 and GSK (RAL-GZ662) guidelines

Features

- Double function air valve, designed for the discharge of small or average air volume allowing air admission into the system during system drainage
- Available with two connection choices: flanged or threaded
- For use in clean water suitable in pipelines up to DN 350
- Minimum working pressure: 0.3 bar
- Built-in 1/4 turn ball valve with a purger that allows the device to be isolated for checking and maintenance
- Available with filter to prevent debris from passing into the sealing zone of the air valve
- It must be installed in a vertical position and according to the following parameters:
 - at the highest point;
 - when accentuating the slope in the flow direction;
 - downstream of control valves fitted on descending pipeline;
 - at regular intervals along ascending/descending pipeline, at least every 500 meters;
- On request possibility of float coating and sealing in NBR.



A

B



Fucoli Somepal
FUNDAÇÃO DE FERRO, S. A.

Visit our website at www.fucoli-somepal.pt

Head office: Estrada de Coselhas, 3000-125 Coimbra – Portugal | Tel.: (+351) 239 490100 | Fax: (+351) 239 490198

Branch office: Rua de Aveiro 50, 3050-420 Pampilhosa – Portugal | Tel.: (+351) 239 490100 | Fax: (+351) 231 949292 | comercial@fucoli-somepal.pt

Ed.8 Rev. 1
09-2023

Being one of the main objectives of our company the development and satisfaction of our customers, we reserve the right to update, change or replace the specifications presented without prior notice.

DOUBLE FUNCTION AIR VALVE
series DOUBLE WIND
DN 20 - 100 PN10/16

06.200

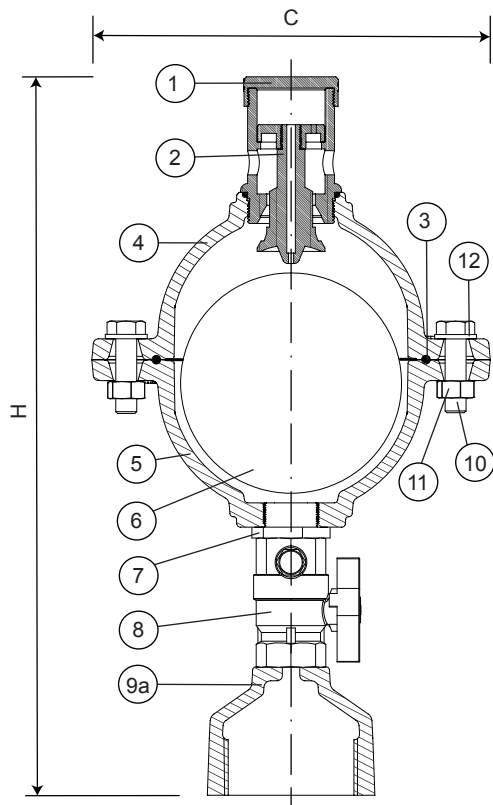

A - Single function air valve threaded model

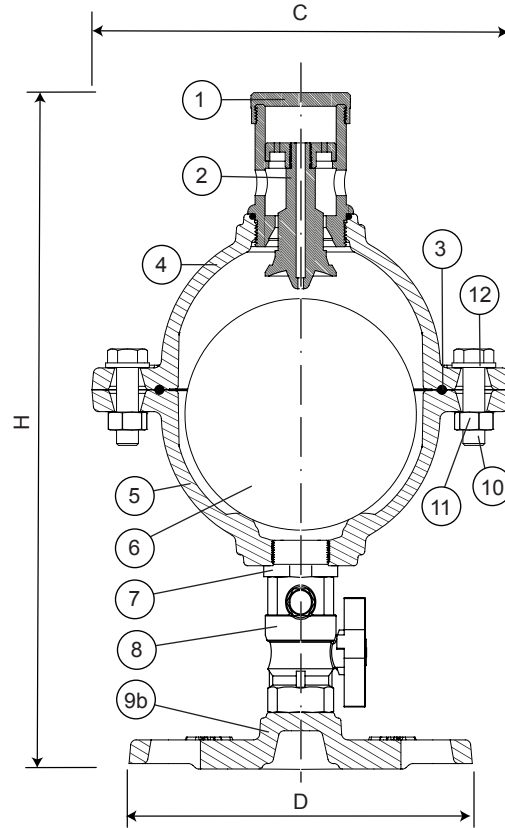

B - Single function air valve flanged model

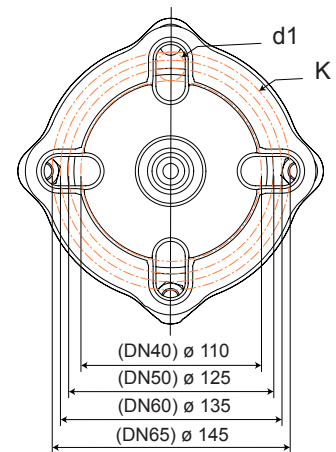
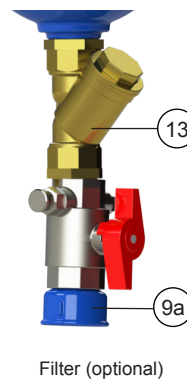
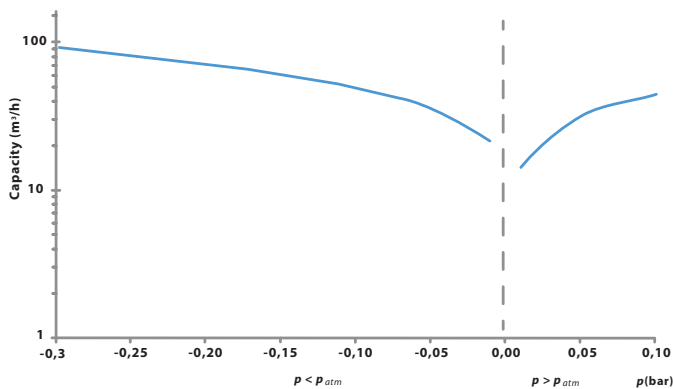

Flange of the single function air valve model

Component list

pos.	components	material	standard
1	Purger with evacuation	Brass CuZn39Pb3	EN 12164
2	Evacuation	Brass CuZn39Pb3	EN 12164
3	O-ring	Elastomer EPDM	EN 681 - 1
4	Bonnet	Ductile iron EN-GJS-500-7	EN 1563
5	Body	Ductile iron EN-GJS-500-7	EN 1563
6	Flutuator	Steel docol 1000DP	-
	Flutuator covering	Elastomer EPDM	EN 681 - 1
7	Bushing	Brass	-

pos.	components	material	standard
8	Ball valve with purger	Brass	-
9a	Threaded	Ductile iron EN-GJS-500-7	EN 1563
9b	Flange	Ductile iron EN-GJS-500-7	EN 1563
10	Bolts	Stainless steel A2	EN 10088 - 1
11	Nuts	Stainless steel A4	EN 10088 - 1
12	Washers	Stainless steel A2	EN 10088 - 1
13	Filter (optional)	Brass	-

continued on next page

DOUBLE FUNCTION AIR VALVE
series DOUBLE WIND
DN 20 - 100 PN10/16

06.200



continued from previous page

A - Single function air valve threaded model

Reference and dimensions

DN	D (BSP)	code	filter S / N	C mm	H mm	Kg approx.
20	G 3/4"	19901115	S	222	435	9
20	G 3/4"	19901114	N	222	340	9
25	G 1"	19901117	S	222	500	10
25	G 1"	19901118	N	222	405	10
32	G 1 1/4"	19901116	S	222	500	10
32	G 1 1/4"	19901104	N	222	405	10
40	G 1 1/2"	19901106	S	222	500	10
40	G 1 1/2"	19901102	N	222	405	10
50	G 2"	19901105	S	222	515	11
50	G 2"	19901103	N	222	420	11

B - Single function air valve flanged model

Reference and dimensions

DN	PN	code	filter S / N	ø D mm	C mm	H mm	K mm	n° x d1 mm	Kg approx.
DN 40/50/60/65	10/16	19901107	S	185	222	465	110/145	4 x 19	12
DN 40/50/60/65	10/16	19901101	N	185	222	370	110/145	4 x 19	11
DN 80	10/16	19907045	S	220	222	465	160/180	8 x 19	13
DN 80	10/16	19907025	N	220	222	370	160/180	8 x 19	13
DN 100	10/16	19907055	S	220	222	465	160/180	8 x 19	13
DN 100	10/16	19907035	N	220	222	370	160/180	8 x 19	13

DN	Main pipe diameter (DN)
G 3/4" to G 2"	40 a 350
40 / 50 / 60 / 65	
80	
100	



Fucoli Somepal
 FUNDIÇÃO DE FERRO, S.A.

Visit our website at www.fucoli-somepal.pt

Head office: Estrada de Coselhas, 3000-125 Coimbra – Portugal | Tel.: (+351) 239 490100 | Fax: (+351) 239 490198

Branch office: Rua de Aveiro 50, 3050-420 Pampilhosa – Portugal | Tel.: (+351) 239 490100 | Fax: (+351) 231 949292 | comercial@fucoli-somepal.pt



100% MADE IN EUROPE