

**FLAP VALVE MOON**  
metal/rubber sealed  
**DN 50 - 1000 PN10/16**

04.301



**Product description**

- Flap valve series MOON for drinking water, neutral liquids and sea water
- Service temperature from 0°C (excluding frost) to 70°C

**Standards**

- Flange drilling to EN 1092-2 PN10/16

**Corrosion protection**

- Epoxy powder coating RAL 5005
- Applied internal and external with a minimum coating thickness of 250 µm
- Potable water approved epoxy coating fusion bonded according EN 14901 and GSK (RAL-GZ662) guidelines

**Features**

- Valve with self-operating flap obturator
- Full bore
- The valve opens under direct pressure to relieve fluid, allowing the water to drain when the pressure is relieved, preventing fluids from returning when the tide rises
- The valve sealing area has an 8° inclination to guarantee automatic closing after the fluid has come out. This inclination allows the obturator to exert sufficient force to prevent the ingress of fluid in the opposite direction.
- Minimum opening pressure is 0.1 bar
- The obturator was sealed to reduce noise and increase the coating's endurance
- Can be installed directly on flanges or previously straightened masonry surfaces by steel anchors prior to being planed
- On request possibility to be supplied with counterweight.



**Fucoli Somepal**  
FUNDAÇÃO DE FERRO, S. A.

Visit our website at [www.fucoli-somepal.pt](http://www.fucoli-somepal.pt)

**Head office:** Estrada de Coselhas, 3000-125 Coimbra – Portugal | Tel.: (+351) 239 490100 | Fax: (+351) 239 490198

**Branch office:** Rua de Aveiro 50, 3050-420 Pampilhosa – Portugal | Tel.: (+351) 239 490100 | Fax: (+351) 231 949292 | [comercial@fucoli-somepal.pt](mailto:comercial@fucoli-somepal.pt)

**FLAP VALVE MOON**  
**metal/rubber sealed**  
**DN 50 - 1000 PN10/16**

04.301



Flap valve Moon

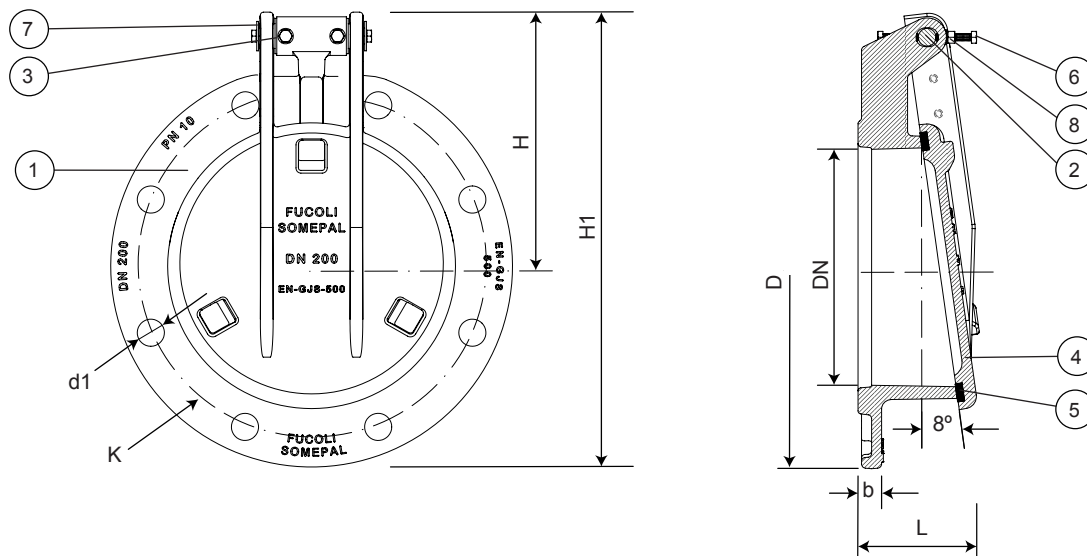

**Component list**

pos.	components	material	standard
1	Body	Ductile iron EN-GJS-500-7	EN 1563
2	Shaft	Stainless steel AISI 316L	EN 10088 - 1
3	Bushing	POM	-
4	Disc/ Obturator	Ductile iron EN-GJS-500-7	EN 1563
5	Sealing	Elastomer NBR	EN 681 - 1
6	Bolts	Stainless steel A2	EN 10088 - 1
7	Washers	Stainless steel A2	EN 10088 - 1
8	Nuts	Stainless steel A4	EN 10088 - 1

**Reference and dimensions**

DN	PN	code	D mm	L mm	H mm	H1 mm	K mm	n° x d1 mm	b mm	Kg approx.
50/60/65	10/16	10765490	185	78	133	226	125/145	4 x 19	19	4
80	10/16	10765495	200	80	154	255	160	8 x 19	19	5
100	10/16	10765500	220	80	154	265	180	8 x 19	19	6
150	10/16	10765505	285	95	184	327	240	8 x 23	19	9
200	10	10765510	340	100	215	386	295	8 x 23	20	14
200	16	10765513	340	100	215	386	295	12 x 23	20	14
250	10	10765515	400	115	252	453	350	12 x 23	22	22
250	16	10765518	400	115	252	453	355	12 x 28	22	22
300	10	10765520	455	125	280	508	400	12 x 23	24.5	28
300	16	10765523	455	125	280	508	410	12 x 28	24.5	28
350	10	10765525	520	140	321	582	460	16 x 23	24.5	50
350	16	10765528	520	140	321	582	470	16 x 28	26.5	50
400	10	10765530	580	150	351	642	515	16 x 28	24.5	50
400	16	10765533	580	150	351	642	525	16 x 31	28	50
450	10	10765535	615	155	370	678	565	20 x 28	25.5	56
450	16	10765538	640	155	370	678	585	20 x 31	30	64
500	10	10765540	670	160	400	736	620	20 x 28	26.5	66
500	16	10765543	715	160	400	736	650	20 x 34	31.5	75
600	10	10765545	780	185	460	851	725	20 x 31	30	97
600	16	10765548	840	185	460	851	770	20 x 37	36	117

continued on next page

**FLAP VALVE MOON**  
metal/rubber sealed  
**DN 50 - 1000 PN10/16**

04.301



continued from previous page

**Reference and dimensions**

DN	PN	code	D mm	L mm	H mm	H1 mm	K mm	n° x d1 mm	b mm	Kg approx.
700	10	10765550	895	210	520	969	840	24 x 31	32.5	130
700	16	10765553	910	210	520	969	840	24 x 37	39.5	150
800	10	10765555	1015	230	582	1091	950	24 x 34	35	180
800	16	10765558	1025	230	582	1091	950	24 x 41	43	200
900	10	10765560	1115	255	646	1210	1050	28 x 34	37.5	200
900	16	10765563	1125	255	646	1210	1050	28 x 41	46.5	250
1000	10/16	10765565	1230/1255	285	712	1340	1160/1170	28 x 37/44	50	295

Flap valve Moon with counterweight

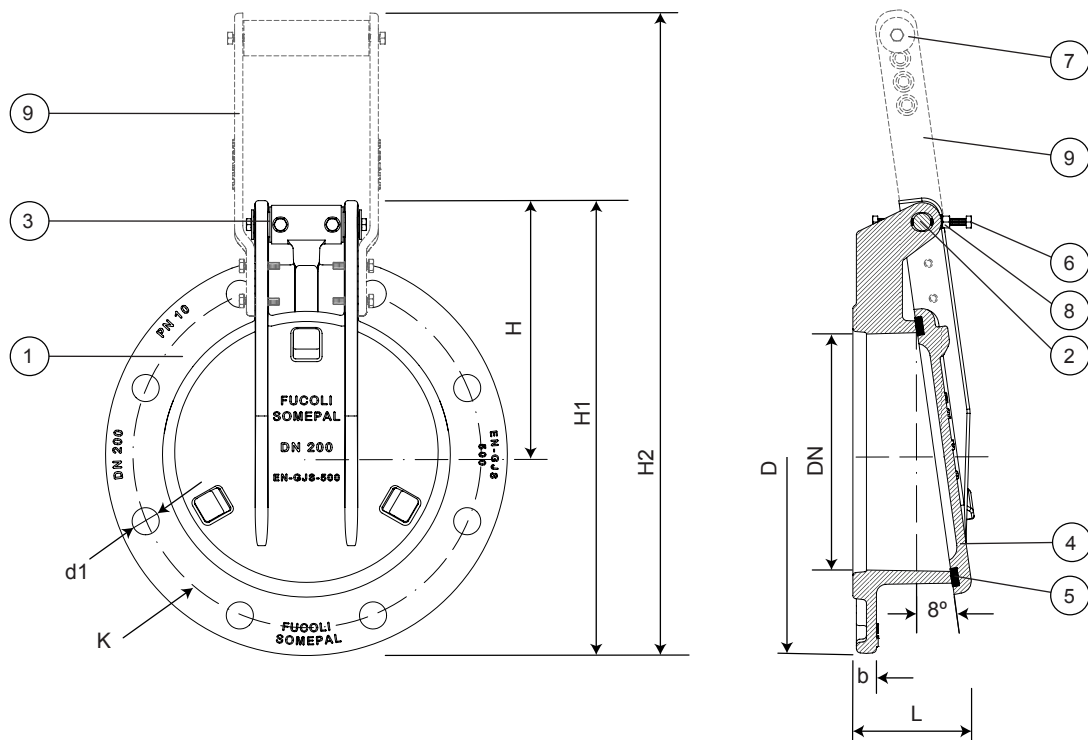

**Component list**

pos.	components	material	standard
1	Body	Ductile iron EN-GJS-500-7	EN 1563
2	Shaft	Stainless steel AISI 316L	EN 10088 - 1
3	Bushing	POM	-
4	Disc/ Obturator	Ferro Fundido Dúctil EN-GJS-500-7	EN 1563
5	Sealing	Elastomer NBR	EN 681 - 1
6	Bolts	Stainless steel A2	EN 10088 - 1
7	Washers	Stainless steel A2	EN 10088 - 1
8	Nuts	Stainless steel A4	EN 10088 - 1
9	Counterweight	Ductile iron EN-GJS-500-7	EN 1563

**Referências e dimensões**

DN	PN	code	D mm	L mm	H mm	H1 mm	H2 mm	K mm	n° x d1 mm	b mm	Kg approx.
50/60/65	10/16	10765590	185	78	133	226	322	125/145	4 x 19	19	6
80	10/16	10765595	200	80	154	255	348	160	8 x 19	19	7
100	10/16	10765600	220	80	154	265	358	180	8 x 19	19	8
150	10/16	10765605	285	95	184	327	490	240	8 x 23	19	11

continued on next page

**FLAP VALVE MOON**  
**metal/rubber sealed**  
**DN 50 - 1000 PN10/16**

04.301



continuação da página anterior

**Reference and dimensions**

DN	PN	code	D mm	L mm	H mm	H1 mm	H2 mm	K mm	n° x d1 mm	b mm	Kg approx.
200	10	10765610	340	100	215	386	545	295	8 x 23	20	17
200	16	10765613	340	100	215	386	545	295	12 x 23	20	17
250	10	10765615	400	115	252	453	612	350	12 x 23	22	25
250	16	10765618	400	115	252	453	612	355	12 x 28	22	25
300	10	10765620	455	125	280	508	716	400	12 x 23	24.5	31
300	16	10765623	455	125	280	508	716	410	12 x 28	24.5	31
350	10	10765625	520	140	321	582	786	460	16 x 23	24.5	55
350	16	10765628	520	140	321	582	786	470	16 x 28	26.5	55
400	10	10765630	580	150	351	642	896	515	16 x 28	24.5	55
400	16	10765633	580	150	351	642	896	525	16 x 31	28	55
450	10	10765635	615	155	370	678	974	565	20 x 28	25.5	61
450	16	10765638	640	155	370	678	974	585	20 x 31	30	69
500	10	10765640	670	160	400	736	1036	620	20 x 28	26.5	71
500	16	10765643	715	160	400	736	1036	650	20 x 34	31.5	80
600	10	10765645	780	185	460	851	1176	725	20 x 31	30	102
600	16	10765648	840	185	460	851	1176	770	20 x 37	36	122
700	10	10765650	895	210	520	969	1334	840	24 x 31	32.5	135
700	16	10765653	910	210	520	969	1334	840	24 x 37	39.5	155
800	10	10765655	1015	230	582	1091	1483	950	24 x 34	35	185
800	16	10765658	1025	230	582	1091	1483	950	24 x 41	43	205
900	10	10765660	1115	255	646	1210	1642	1050	28 x 34	37.5	205
900	16	10765663	1125	255	646	1210	1642	1050	28 x 41	46.5	255
1000	10/16	10765665	1230/1255	285	712	1340	1770	1160/1170	28 x 37/44	50	300



**Fucoli Somepal**  
 FUNDAÇÃO DE FERRO, S.A.

Visit our website at [www.fucoli-somepal.pt](http://www.fucoli-somepal.pt)

Head office: Estrada de Coselhas, 3000-125 Coimbra – Portugal | Tel.: (+351) 239 490100 | Fax: (+351) 239 490198

Branch office: Rua de Aveiro 50, 3050-420 Pampilhosa – Portugal | Tel.: (+351) 239 490100 | Fax: (+351) 231 949292 | [comercial@fucoli-somepal.pt](mailto:comercial@fucoli-somepal.pt)

