

MOVABLE FLANGED UPVC SOCKET 90° DUCKFOOT BEND

01.104

Fittings

DN 80 - 150 PN10/16



Product description

- Movable flanged uPVC socket 90° duckfoot bend for drinking water and neutral liquids
- Service temperature from 0°C (excluding frost) to 70°C

Standards

- Designed according to EN 12842
- Flange drilling to EN 1092-2 PN10/16
- For PVC pipes according to EN ISO 1452-2

Corrosion protection

- Epoxy powder coating RAL 5005
- Applied internal and external with a minimum coating thickness of 250 µm
- Potable water approved epoxy coating fusion bonded according EN 14901 and GSK (RAL-GZ662) guidelines

Approvals

- ACS Potability Certificate 21 ACC NY 004

Features

- Fitting approved for drinking water
- Body and flange in ductile iron cast iron EN-GJS-500-7
- Fast and easy to install
- Suitable for uPVC pipe
- Socket ends with EPDM double lip seal ring to ensure a perfect sealing.



Fucoli Somepal
FUNDAÇÃO DE FERRO, S. A.

Visit our website at www.fucoli-somepal.pt

Head office: Estrada de Coselhas, 3000-125 Coimbra – Portugal | Tel.: (+351) 239 490100 | Fax: (+351) 239 490198

Branch office: Rua de Aveiro 50, 3050-420 Pampilhosa – Portugal | Tel.: (+351) 239 490100 | Fax: (+351) 231 949292 | comercial@fucoli-somepal.pt

MOVABLE FLANGED UPVC SOCKET 90° DUCKFOOT BEND

Fittings

DN 80 - 150 PN10/16

01.104

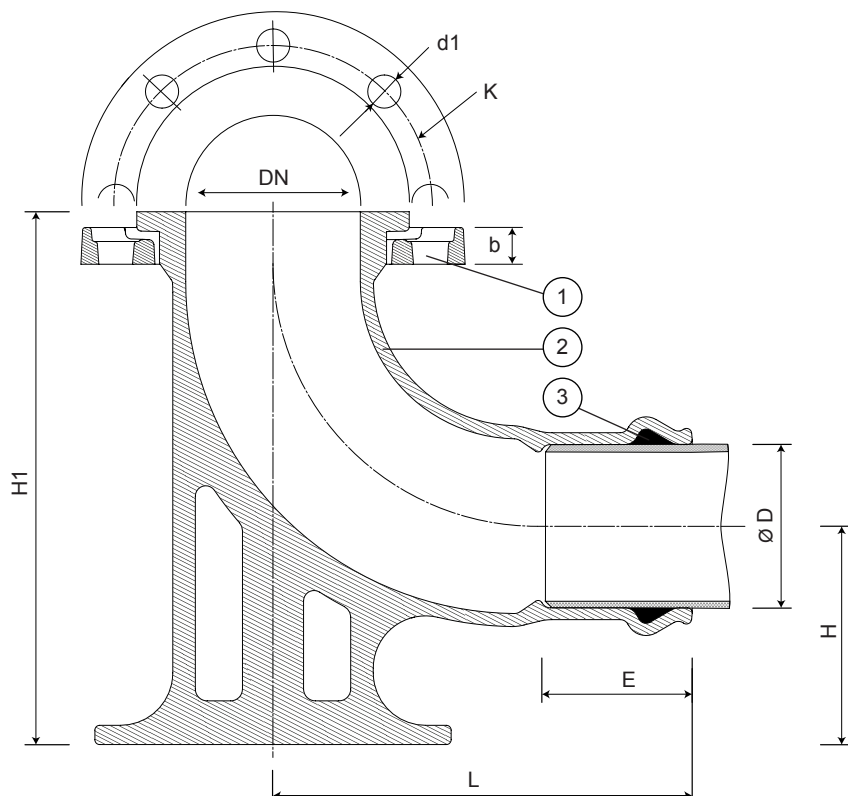

Component list

pos.	components	material	standard
1	Flange	Ductile iron EN-GJS-500-7	EN 1563
2	Body	Ductile iron EN-GJS-500-7	EN 1563
3	Lip seal ring	Elastomer EPDM	EN 681 - 1

Reference and dimensions

DN	Ø D ext. PVC	PN	code	L mm	E min	H mm	H1 mm	K mm	n° x d1 mm	b mm	Kg approx.
80	90	10/16	10001052	259	76	108	290	160	8 x 19	21	14
80	110	10/16	10001053	303	115	120	300	160	8 x 19	21	14
100	90	10/16	10001064	240	86	125	305	180	8 x 19	21	14
100	110	10/16	10001066	260	115	125	305	180	8 x 19	21	15
100	140	10/16	10001067	275	111	125	305	180	8 x 19	21	16
100	160	10/16	10001069	300	123	125	305	180	8 x 19	21	18
100	200	10/16	10001071	310	132	125	305	180	8 x 19	21	20
125	140	10/16	10001068	295	110	120	320	210	8 x 19	21	20
150	160	10/16	10001081	322	123	120	340	240	8 x 23	21	29
150	200	10/16	10001082	330	132	120	340	240	8 x 23	21	29



Fucoli Somepal
FUNDIÇÃO DE FERRO, S.A.

Visit our website at www.fucoli-somepal.pt

Head office: Estrada de Coselhas, 3000-125 Coimbra – Portugal | Tel.: (+351) 239 490100 | Fax: (+351) 239 490198

Branch office: Rua de Aveiro 50, 3050-420 Pampilhosa – Portugal | Tel.: (+351) 239 490100 | Fax: (+351) 231 949292 | comercial@fucoli-somepal.pt



100% MADE IN EUROPE