

FLANGED SOFT SEALING GATE VALVE S14 NEXUS

with position indicator
DN 50 - 300 PN10/16

01.610



Product description

- Flanged soft sealing gate valve series NEXUS with position indicator for drinking water and neutral liquids
- Service temperature from 0°C (excluding frost) to 70°C

Standards

- Designed according to EN 1074 part 1 & 2 and EN 1171
- Flange drilling to EN 1092-2 PN10/16
- Face-to-face according to EN 558 series 14

Tests

All valves are individually hydrostatically tested according to EN 1074-1/2 and EN 12266:

- Seal 1.1 x PN (in bar); Body: 1.5 x PN (in bar). Operation torque test

Corrosion protection

- Epoxy powder coating RAL 5005
- Applied internal and external with a minimum coating thickness of 250 µm
- Potable water approved epoxy coating, fusion bonded according to DIN 3476-1, EN 14901-1 and GSK approved

Approvals

- GSK Certificate GSK-ID:1247 (RAL-GZ 662)

Features

- Isolation valve approved for drinking water
- Full bore
- Low operating torque
- Brass stem washer provides stress fixation and low operating torque
- Stainless steel stem with rolled threads produced by cold rolling process, which keeps the steel structure and increase its mechanical resistance
- Stem with stainless steel wedge stop to serve as backstop when the valve is fully open
- Stem sealing with POM bearing with 4 O-rings and a bottom joint in EPDM
- Wedge fully vulcanized with drinking water approved EPDM
- Wedge of polyamide coated guide rails avoiding friction and corrosion
- Wedge with brass nut fixed in the wedge core preventing vibration and ensure a long life span
- Round EPDM bonnet gasket fixed in a recess, surrounding the bolts, ensuring a perfect seal
- Body/bonnet bolts in stainless steel A2 encased and sealed ensuring full corrosion protection
- Position indicator for visual display of gate position
- On request possibility of stem in stainless steel AISI 316L, NBR sealings and wedge nut in different brass alloys.



RAL GUTZEICHEN
SCHWEISZ KENNZEICHEN
VON ARMATUREN UND FORMSTÜCKEN



Fucoli-Somepal
FUNDAÇÃO DE FERRO, S.A.

Visit our website at www.fucoli-somepal.pt

Head office: Estrada de Coselhas, 3000-125 Coimbra – Portugal | Tel.: (+351) 239 490100 | Fax: (+351) 239 490198

Branch office: Rua de Aveiro 50, 3050-420 Pampilhosa – Portugal | Tel.: (+351) 239 490100 | Fax: (+351) 231 949292 | comercial@fucoli-somepal.pt

FLANGED SOFT SEALING GATE VALVE S14 NEXUS

with position indicator
DN 50 - 300 PN10/16

01.610

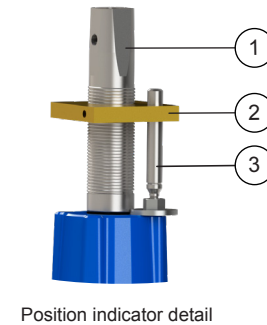
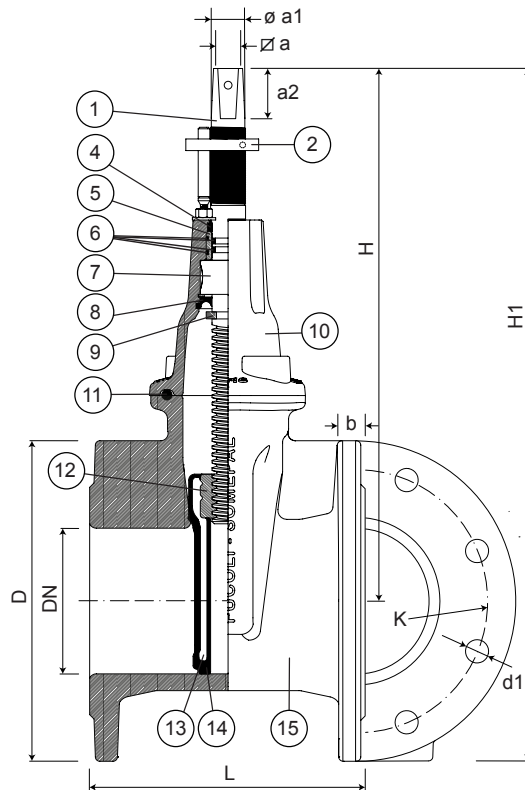

Component list

pos	components	material	standard
1	Stem	Stainless steel AISI 420	EN 10088-1
2	Position indicator	Brass	EN 12164
3	Indicator guide	Stainless steel AISI 420	EN 10088-1
4	Clearing joint	Elastomer	-
5	Bearing	POM	-
6	O-rings	Elastomer EPDM	EN 681-1
7	Stem washer	Brass DZR CW602N	EN 12164
8	Joint	Elastomer EPDM	EN 681-1

pos	components	material	standard
9	Wedge stop	Stainless steel AISI 420	EN 10088-1
10	Bonnet	Ductile iron EN-GJS-500-7	EN 1563
11	Bonnet gasket	Elastomer EPDM	EN 681-1
12	Wedge nut	Brass DZR CW626N	EN 12164
13	Wedge	Ductile iron EN-GJS-500-7	EN 1563
14	Wedge covering	Elastomer EPDM	EN 681-1
15	Body	Ductile iron EN-GJS-500-7	EN 1563

Reference and dimensions

DN	PN	code	D mm	L mm	H mm	H1 mm	K mm	n° x d1 mm	b mm	$\varnothing a$ mm	$\varnothing a1$ mm	a2 mm	turns to open	Kg approx.
50	10/16	10729210	165	150	277	360	125	4 x 19	19	14.1	18	29	13	10
60*	10/16	10729215FL	185	170	305	397	135	4 x 19	19	17.1	22	34	14	12
65	10/16	10729215	185	170	305	397	145	4 x 19	19	17.1	22	34	14	12
80	10/16	10729220	200	180	335	435	160	8 x 19	19	17.1	22	34	16	14
100	10/16	10729225	220	190	368	476	180	8 x 19	19	19.1	23	38	20	17
125	10/16	10729230	250	200	407	532	210	8 x 19	19	19.1	23	38	25	22
150	10/16	10729235	285	210	458	600	240	8 x 23	19	19.1	26	38	30	31
200	10	10729240	340	230	531	701	295	8 x 23	20	24.1	28	38	40	47
200	16	10729245	340	230	531	701	295	12 x 23	20	24.1	28	38	40	47
250	10	10729250	400	250	-	-	350	12 x 23	22	27.1	32	47	42	72
250	16	10729255	400	250	-	-	355	12 x 28	22	27.1	32	47	42	72
300	10	10729260	455	270	-	-	400	12 x 23	24.5	27.1	32	47	50	98
300	16	10729265	455	270	-	-	410	12 x 28	24.5	27.1	32	47	50	98

* DN65 valve with DN60 flange drilling



Fucoli-Somepal
FUNDAÇÃO DE FERRO, S. R. L.

Visit our website at www.fucoli-somepal.pt

Head office: Estrada de Coselhas, 3000-125 Coimbra – Portugal | Tel.: (+351) 239 490100 | Fax: (+351) 239 490198

Branch office: Rua de Aveiro 50, 3050-420 Pampilhosa – Portugal | Tel.: (+351) 239 490100 | Fax: (+351) 231 949292 | comercial@fucoli-somepal.pt



100% MADE IN EUROPE