

WALL FIRE PLUG for fire fighting

07.600



Product description

- Wall fire plug

Features

- Body and top sealing in brass
- Top sealing are easy to replace
- Maximum working pressure 16 bar
- Painting in RAL 3000.
- Available in 2 models:
 - A. Storz outlet
 - B. Thread outlet

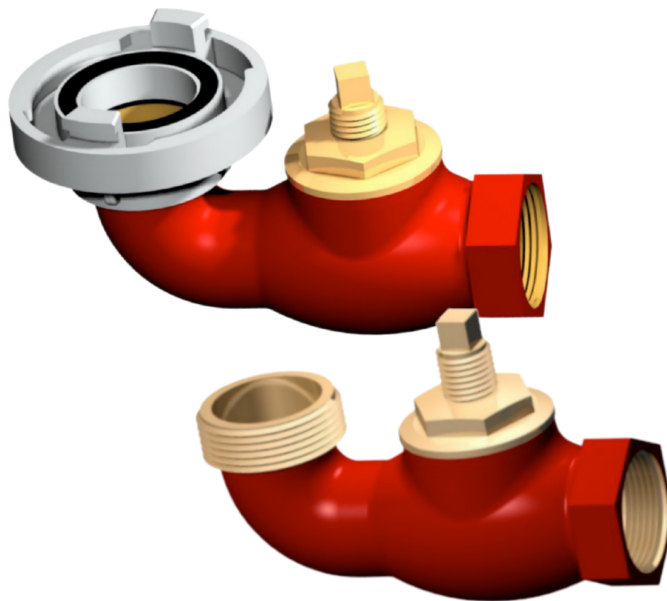

Fucoli Somepal
FUNDAÇÃO DE FERRO, S. A.

Visit our website at www.fucoli-somepal.pt

Head office: Estrada de Coselhas, 3000-125 Coimbra – Portugal | Tel.: (+351) 239 490100 | Fax: (+351) 239 490198

Branch office: Rua de Aveiro 50, 3050-420 Pampilhosa – Portugal | Tel.: (+351) 239 490100 | Fax: (+351) 231 949292 | comercial@fucoli-somepal.pt

Ed.8 Rev. 0
02-2022

Being one of the main objectives of our company the development and satisfaction of our customers, we reserve the right to update, change or replace the specifications presented without prior notice.

WALL FIRE PLUG for fire fighting

07.600

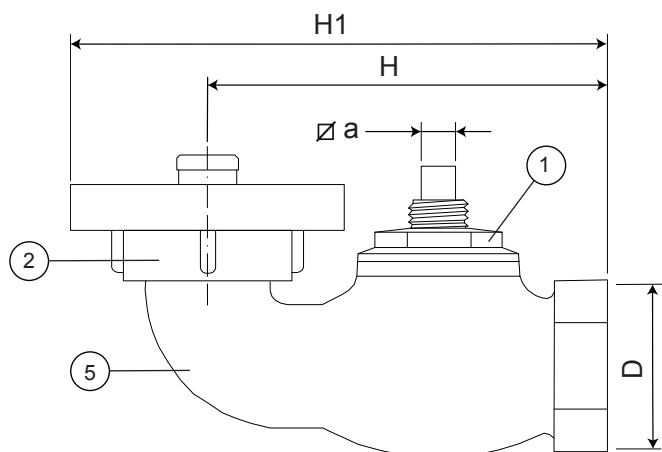

For wall without branch / storz

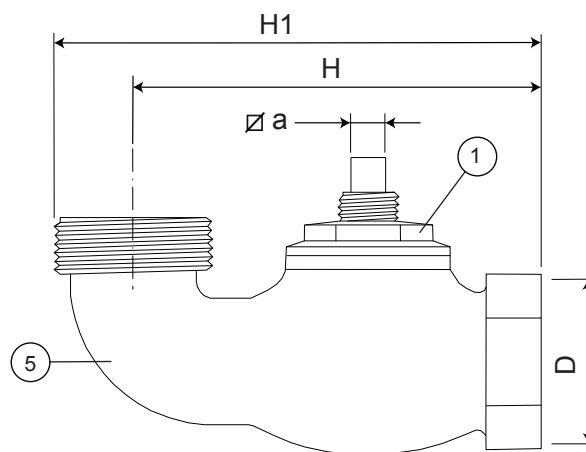

For wall without branch / thread

Component list

pos.	components	material	standard
1	Top sealing	Brass	EN 1982
2	Body	Brass	EN 1982
	Obturator	Brass	EN 1982
	Sealing	Elastomer EPDM	EN 681-1
5	Fire hose coupling storz	Stainless steel AISI 12	EN 1706

Reference and dimensions

code	designation	Inlet D (BSP)	Outlet	$\varnothing a$ mm	H mm	H1 mm	Kg approx.
10509060	For wall without branch / storz	G 1 1/2"	Storz 52	13	142	186	2
10509010	For wall without branch / thread	G 1 1/2"	W 2 1/8"	13	142	186	2



Fucoli Somepal
FUNDIÇÃO DE FERRO, S.A.

Visit our website at www.fucoli-somepal.pt

Head office: Estrada de Coselhas, 3000-125 Coimbra – Portugal | Tel.: (+351) 239 490100 | Fax: (+351) 239 490198

Branch office: Rua de Aveiro 50, 3050-420 Pampilhosa – Portugal | Tel.: (+351) 239 490100 | Fax: (+351) 231 949292 | comercial@fucoli-somepal.pt

