

ALL SOCKET CROSSHEAD FOR uPVC

Fittings for uPVC pipes

63 - 400 PN10/16/25

10.600



Product description

- All socket crosshead for uPVC pipes for drinking water and neutral liquids
- Service temperature from 0°C (excluding frost) to 70°C

Standards

- Designed according to EN 12842
- For uPVC pipes according EN ISO 1452-2

Corrosion protection

- Epoxy powder coating RAL 5005
- Applied internal and external with a minimum coating thickness of 250 µm
- Potable water approved epoxy coating fusion bonded according EN 14901 and GSK (RAL-GZ662) guidelines

Approvals

- ACS Potability Certificate 21 ACC NY 004

Features

- Fitting approved for drinking water for uPVC pipes connection
- Body in ductile cast iron (EN-GJS-500-7)
- Fast and easy to install
- Socket ends with drinking water approved EPDM double lip seal ring to ensure a perfect sealing
- Maximum working pressure 25 bar, the maximum working and test pressure must be in accordance with the pipe standard
- This fitting does not guarantee the pipe blocking, they must be anchored by other means
- On request possibility of sealing ring in NBR.



Fucoli Somepal
FUNDAÇÃO DE FERRO, S. A.

Visit our website at www.fucoli-somepal.pt

Head office: Estrada de Coselhas, 3000-125 Coimbra – Portugal | Tel.: (+351) 239 490100 | Fax: (+351) 239 490198

Branch office: Rua de Aveiro 50, 3050-420 Pampilhosa – Portugal | Tel.: (+351) 239 490100 | Fax: (+351) 231 949292 | comercial@fucoli-somepal.pt

ALL SOCKET CROSSHEAD FOR uPVC

Fittings for uPVC pipes
63 - 400 PN10/16/25

10.600

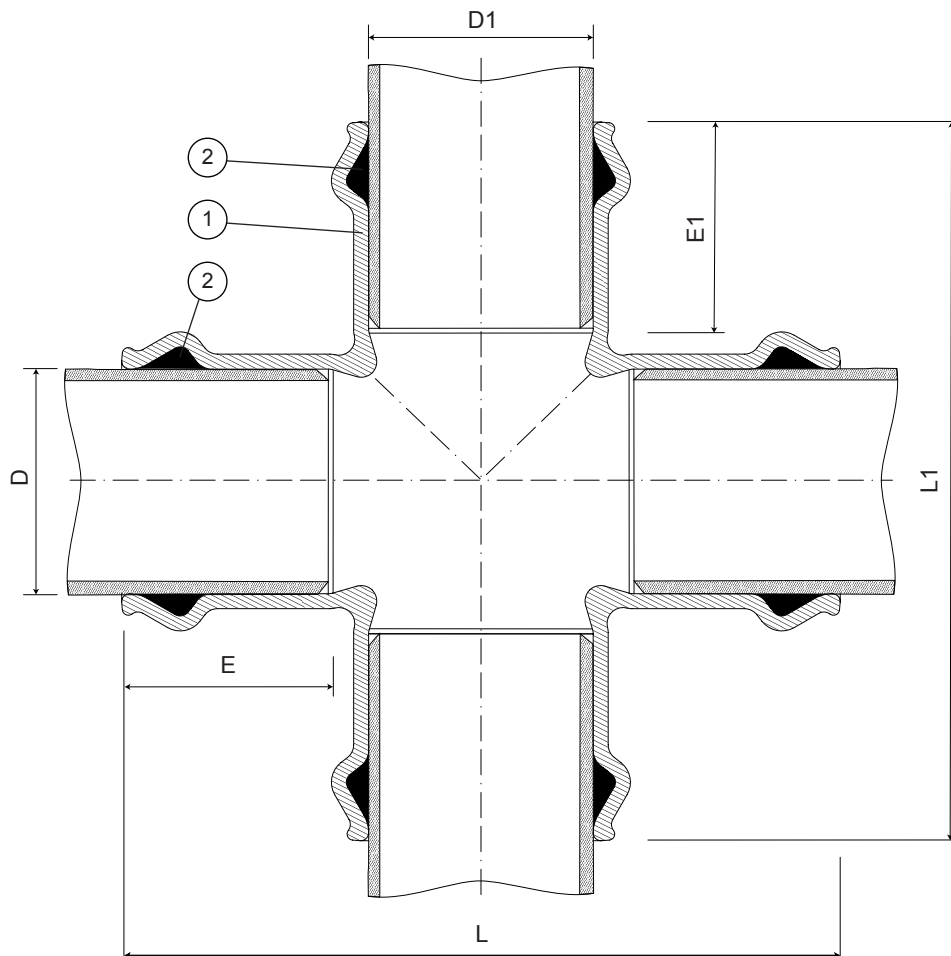

Component list

pos.	components	material	standard
1	Body	Ductile iron EN-GJS-500-7	EN 1563
2	Sealing ring	Elastomer EPDM	EN 681 - 1

Reference and dimensions

Ø D x Ø D1 ext. PE/uPVC	code	L mm	L1 mm	E mm	E1 mm	Kg approx.
63 x 63	1043700001	260	260	88	88	6
75 x 75	1043701001	280	280	90	90	7
90 x 90	1043702001	316	316	97	97	8
110 x 110	1043703001	360	360	105	105	12
125 x 125	1043703501	404	404	108	108	16
140 x 140	1043704001	412	412	110	110	17
160 x 160	1043705001	461	461	123	123	23
200 x 200	1043706601	520	520	132	132	31
250 x 250	1043707001	627	627	145	145	53
315 x 315	1043708001	746	746	160	160	83
400 x 400	1043709001	960	978	173	173	150



Fucoli Somepal
FUNDAÇÃO DE FERRO, S.A.

Visit our website at www.fucoli-somepal.pt

Head office: Estrada de Coselhas, 3000-125 Coimbra – Portugal | Tel.: (+351) 239 490100 | Fax: (+351) 239 490198

Branch office: Rua de Aveiro 50, 3050-420 Pampilhosa – Portugal | Tel.: (+351) 239 490100 | Fax: (+351) 231 949292 | comercial@fucoli-somepal.pt



100% MADE IN EUROPE