



De DN40 a DN250 – flange móvel  
From DN40 to DN250 – movable flange



A partir de DN300 – flange fixa  
From DN300 – fixed flange

# FORQUILHA FLANGEADA A 45° FLANGED 45° TEE

10.1700

PN 10 / 16 / 25

Flange	EN 1092-2
--------	-----------

A partir de DN 300 inclusive as forquilhas são de flange fixa.

From DN 300 inclusively the flanged 45° tees are with fixed flanges.

componente	material	component	material	norma	standard
corpo e flanges	ferro fundido dúctil (EN-GJS-500-7)	body and flanges	ductile iron (EN-GJS-500-7)	EN 1563	
revestimento anticorrosivo interior e exterior	tinta epóxica potável RAL 5005 aplicada electrostaticamente com espessura ≥ 250 µm	coating inside and outside	epoxy paint potable RAL 5005 applied electrostatically with thickness ≥ 250 µm	DIN 30677 e de acordo com as especificações da GSK (RAL-GZ662) and according to the requirements of GSK (RAL-GZ662)	

**Sob Consulta:**  
Outros diâmetros.

**On request:**  
Other diameters.

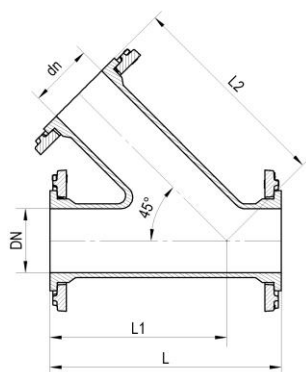

DN	dn	código - code			L	L1	L2	peso - Weight (Kg)		
		PN 10	PN 16	PN 25				PN 10	PN 16	PN 25
40	40	10150200	10150200	10150300	255	210	220	8.0	8.0	-
50	50	10150205	10150205	10150305	280	225	245	8.0	8.0	-
60	60	10150210	10150210	10150310	305	250	270	10.0	10.0	-
65	65	10150215	10150215	10150315	305	250	270	13.0	13.0	-
80	80	10150220	10150220	10150320	330	270	290	15.0	15.0	-
100	100	10150225	10150225	10150325	360	275	325	20.0	20.0	-
125	125	10150230	10150230	10150330	440	365	370	30.0	30.0	-
150	150	10150235	10150235	10150335	500	414	410	31.0	31.0	-
200	200	10150240	10150240	10150340	560	465	480	53.0	53.0	-
250	250	10136060	10136065	10182000	600	470	555	93.0	93.0	-
300	300	10136070	10136075	10182005	800	660	660	184.0	190.0	-
350	350	10136310	10136315	10182010	900	750	750	198.0	-	-
400	400	10136320	10136322	10182015	970	815	830	210.0	-	-
450	450	10136330	10136335	10182020	1050	880	890	240.0	-	-
500	500	10136340	10136345	10182025	1140	960	970	494.0	-	-
600	600	10136350	10136355	10182030	1320	1100	1110	773.0	804.0	-
700	700	10136360	10136365	10182035	1500	1250	1260	880.0	-	-
800	800	10136370	10136375	10182040	1700	1410	1420	1100.0	-	-
900	900	10136380	10136385	10182045	1850	1530	1550	1500.0	-	-
1000	1000	10136390	10136395	10182050	2000	1680	1710	1800.0	-	-



temperatura máxima de trabalho  
maximum working temperature

até 70°C  
up to 70°C

### homologações - homologation

revestimento – coating (RAL 5005)

- CARSO (Alemanha - Germany)
- WRAS (Reino Unido - United Kingdom)
- HYGIENE Institut Ruhrgebiets (Alemanha - Germany)
- KIWA (Holanda - Netherlands)
- AGES (Alemanha - Germany)
- STAZIONE SPERIMENTALE PER L'INDUSTRIA DELLE CONSERVE ALIMENTARI (Itália - Italy)
- NATIONAL INSTITUTE OF PUBLIC HEALTH (República Checa - Czech Republic)
- REGIONAL INSTITUTE OF PUBLIC HEALTH (República Checa - Czech Republic)