

ROUND MANHOLE COVER

SERIES PROGRESS

C250 e D400

12.110



Product description

- Round manhole cover series PROGRESS
- Water based black painting

Installation location

- Class C250 - For gully tops, installed in the area of kerbside channels of roads which when measured from the kerb edge, extends a maximum of 0,5 m into the carriageway and a maximum of 0,2 m into the pedestrian area
- Class D400 - Carriageways of roads (including pedestrian streets), hard shoulders and parking areas for all types of road vehicles
- Heavy/normal traffic zone and periodic visits

Standards

- Designed according to EN 124-1/2

Certifications

- Certificate Certif "D400" DDA - 001/2024

Features

- Ductile cast iron cover and frame (EN-GJS-500-7) with water based black painting
- Cover with non-slip raised pattern according to EN 124-1 designed to allow quick and easy installation
- Simple hinged manhole with a simple opening at 110° and a safety 90° blocking device
- Removing the cover and setting it vertically on the frame
- System through an elastic arm in ductile cast iron, incorporated in the cover
- Frame prepared to install the anti-theft system
- Hinge system with self-cleaning system
- The cover have a local to install an additional security lock. This lock may be conventional or inviolable and can be installed at any moment
- Elastic seating which assures the cover perfectly fits the frame and also gives stability and silent operating even in high traffic intensity
- Stability conferred by the 6 guides in the cover for centrally positioned and stability in the frame, while minimizing the movement of the cover relative to the frame, ensures the horizontal and vertical stability of the set
- Personalization of the cover with inscriptions and logo in high relief with minimal quantities.



Fucoli Somepal
FUNDAÇÃO DE FERRO, S. A.

Visit our website at www.fucoli-somepal.pt

Head office: Estrada de Coselhas, 3000-125 Coimbra – Portugal | Tel.: (+351) 239 490100 | Fax: (+351) 239 490198

Branch office: Rua de Aveiro 50, 3050-420 Pampilhosa – Portugal | Tel.: (+351) 239 490100 | Fax: (+351) 231 949292 | comercial@fucoli-somepal.pt

ROUND MANHOLE COVER
SERIES PROGRESS
C250 e D400

12.110



Model with 75 mm height frame



Model with 100 mm height frame

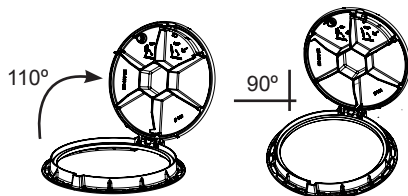

Maximum opening at 110°

Safety 90° blocking

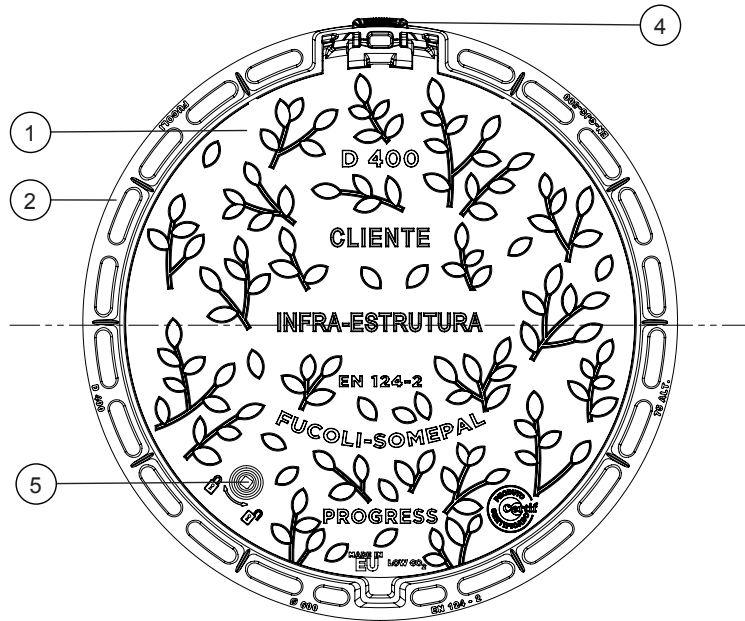
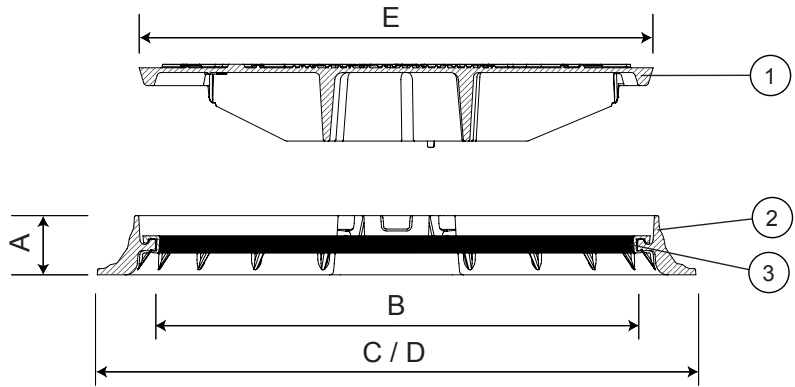

Product features



System to open the cover

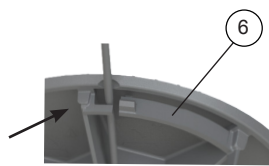

System to unlock and open the cover

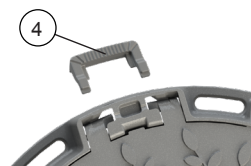

Anti-theft system [A-R]

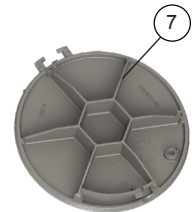

Stability conferred by the 6 guides of the cover

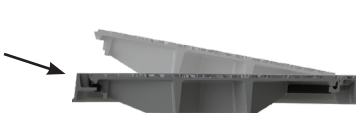

6 Closing and blocking system



5 Conventional additional security lock [F-S]



5 Inviolable additional security lock [F-S-I]

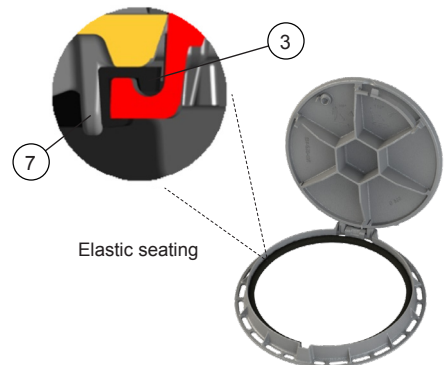

Elastic seating

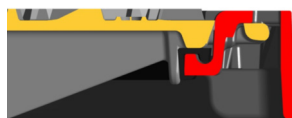

Self-cleaning detail of hinge system

continued on next page

ROUND MANHOLE COVER

SERIES PROGRESS

C250 e D400

12.110



continued from previous page

Component list

pos.	components	material	standard
1	Cover	Ductile iron EN-GJS-500-7	EN 1563
2	Frame	Ductile iron EN-GJS-500-7	EN 1563
3	Elastic seating anti-noise	EVA copolymer	-
4	Anti-theft system [A-R]	Ductile iron EN-GJS-500-7	EN 1563
5	Conventional security lock	Steel Zinc plated 8.8	-
6	Elastic arm	Ductile iron EN-GJS-500-7	EN 1563
7	Guide of the cover	Ductile iron EN-GJS-500-7	EN 1563

Reference and dimensions

Subtitle:
 Lock - Conical closing system
 [F-S] - Conventional security lock
 [F-S-I] - Inviolable security lock
 [A-R] - Anti-theft system

DN - Class - Model	code	Lock	[F-S]	[F-S-I]	[A-R]	Frame				Cover	Weight	
						height	clear	ø external	ø ext. with	ø external	Cover	Total
						mm	opening	mm	stone-bolt	mm	kg	kg
A	B	C	D	E	approx.	approx.						
600 - D400 75 Altura	24B1CI4AAFBBBBZZZZ00EE	•				75	600	765	765	650	33	52
600 - D400 75 Altura	24B1CI4AAFBBBBZZZZ00GE	•	•			75	600	765	765	650	33	52
600 - D400 75 Altura	24B1CI4AAFBBBBZZZZ00HE	•		•		75	600	765	765	650	33	52
600 - D400 75 Altura	24B1CI4AAFBBBBZZZZ00IE	•			•	75	600	765	765	650	33	52
600 - D400 75 Altura	24B1CI4AAFBBBBZZZZ00JE	•	•		•	75	600	765	765	650	33	52
600 - D400 75 Altura	24B1CI4AAFBBBBZZZZ00KE	•		•	•	75	600	765	765	650	33	52
600 - D400 100 Altura	24B1CI4AAIBBBBBZZZZ00EE	•				100	600	850	850	650	33	59
600 - D400 100 Altura	24B1CI4AAIBBBBBZZZZ00GE	•	•			100	600	850	850	650	33	59
600 - D400 100 Altura	24B1CI4AAIBBBBBZZZZ00HE	•		•		100	600	850	850	650	33	59
600 - D400 100 Altura	24B1CI4AAIBBBBBZZZZ00IE	•			•	100	600	850	850	650	33	59
600 - D400 100 Altura	24B1CI4AAIBBBBBZZZZ00JE	•	•		•	100	600	850	850	650	33	59
600 - D400 100 Altura	24B1CI4AAIBBBBBZZZZ00KE	•		•	•	100	600	850	850	650	33	59
600 - C250 75 Altura	24B1CI3AAFBBBBZZZZ00EE	•				75	600	765	765	605	33	-
600 - C250 75 Altura	24B1CI3AAFBBBBZZZZ00GE	•	•			75	600	765	765	605	33	-
600 - C250 75 Altura	24B1CI3AAFBBBBZZZZ00HE	•		•		75	600	765	765	605	33	-
600 - C250 75 Altura	24B1CI3AAFBBBBZZZZ00IE	•			•	75	600	765	765	605	33	-
600 - C250 75 Altura	24B1CI3AAFBBBBZZZZ00JE	•	•		•	75	600	765	765	605	33	-
600 - C250 75 Altura	24B1CI3AAFBBBBZZZZ00KE	•		•	•	75	600	765	765	605	33	-



Fucoli Somepal
 FUNDAÇÃO DE FERRO, S. A.

Visit our website at www.fucoli-somepal.pt

Head office: Estrada de Coselhas, 3000-125 Coimbra – Portugal | Tel.: (+351) 239 490100 | Fax: (+351) 239 490198

Branch office: Rua de Aveiro 50, 3050-420 Pampilhosa – Portugal | Tel.: (+351) 239 490100 | Fax: (+351) 231 949292 | comercial@fucoli-somepal.pt



100% MADE IN EUROPE